

# Flexi-Tape (3528)

- LED Flexi-Tape is an eye pleasing, functional solution for a broad range of lighting applications
- Environmentally friendly, energy efficient and easy to install
- Available in six vivid LED colors
- Available in 12V & 24V
- UL, CSA and FAA approved options available
- Several different mounting options available

## Flexi-Tape w/30 LEDs per meter

COLOR	COLOR TEMP WAVE LENGTH	LUMINOUS ITENSITY (mcd)	LUMENS PER FOOT	MAX AMPS per FOOT	MAX RUN LENGTH
White	5500 - 6500K	x	63	.06A	59 ft.
Warm White	2800 - 3200K	x	58	.06A	59 ft.
Red	620 - 636nm	500 - 800	x	.06A	59 ft.
Amber/Yellow	585 - 596nm	500 - 800	x	.06A	59 ft.
Blue	460 - 470nm	300 - 600	x	.06A	59 ft.
Green	515 - 530nm	1000 - 1500	x	.06A	59 ft.

## Flexi-Tape w/60LEDs per meter

COLOR	COLOR TEMP WAVE LENGTH	LUMINOUS ITENSITY (mcd)	LUMENS PER FOOT	MAX AMPS per FOOT	MAX RUN LENGTH
White	5500 - 6500K	x	126	.12A	39.37 ft.
Warm White	2800 - 3200K	x	117	.12A	39.37 ft.
Red	620 - 636nm	500 - 800	x	.12A	39.37 ft.
Amber/Yellow	585 - 596nm	500 - 800	x	.12A	39.37 ft.
Blue	460 - 470nm	300 - 600	x	.12A	39.37 ft.
Green	515 - 530nm	1000 - 1500	x	.12A	39.37 ft.

Flexi-Tape w/120 LEDs per meter

COLOR	COLOR TEMP WAVE LENGTH	LUMINOUS ITENSITY (mcd)	LUMENS PER FOOT	MAX AMPS per FOOT	MAX RUN LENGTH
White	5500 - 6500K	x	252	.24A	19.5 ft.
Warm White	2800 - 3200K	x	234	.24A	19.5 ft.
Red	620 - 636nm	500 - 800	x	.24A	19.5 ft.
Amber/Yellow	585 - 596nm	500 - 800	x	.24A	19.5 ft.
Blue	460 - 470nm	300 - 600	x	.24A	19.5 ft.
Green	515 - 530nm	1000 - 1500	x	.24A	19.5 ft.

Available profiles:

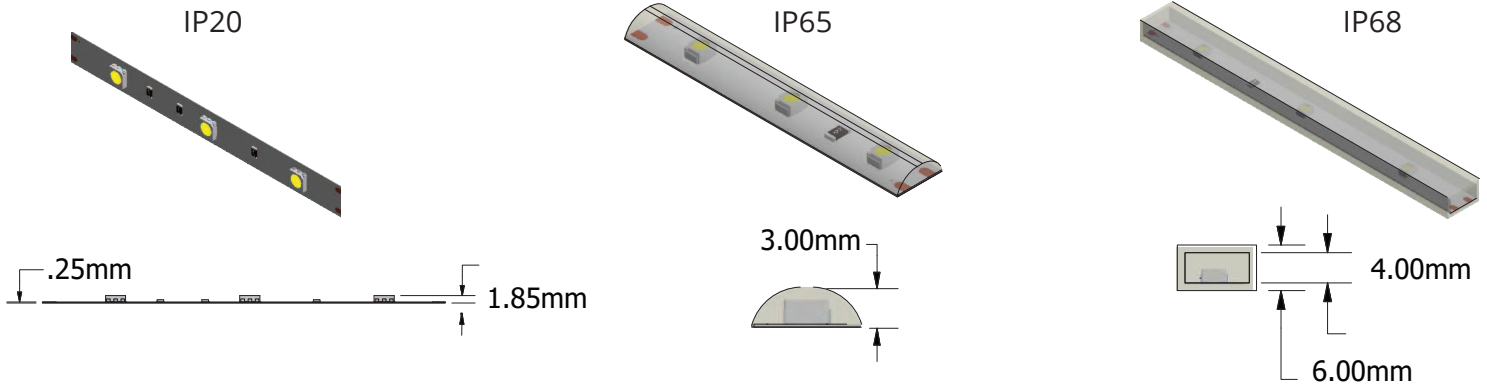

Mounting options:

Flexi-Tape Versa-Lite Tube  
(3528 Standard Flexi-Tape only)

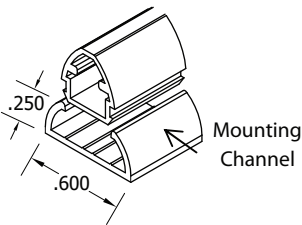
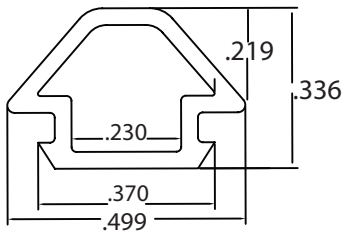

3528 Waterproof Flexi-Tape  
Plastic Clip (10MMCL)

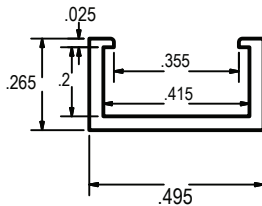
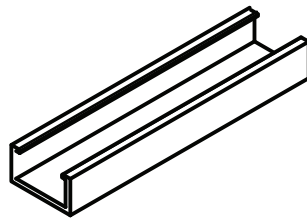

3528 Waterproof Flexi-Tape  
Aluminum Channel (10MMCH)

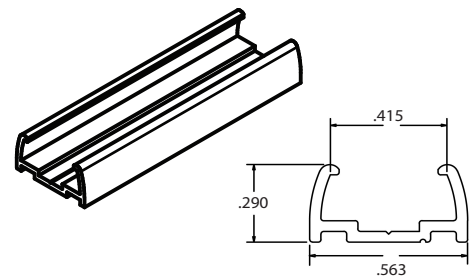

10mm Endcap  
(10MMEC)

